

NOTE: Must leave access walkway to Exit door.
Adjust back drape for booth #149 to accommodate.

Minimum distance from wall
for 8' back drape = 44"

NOTE: Start floor tape with
booth 160; dimensions off
walls as shown.

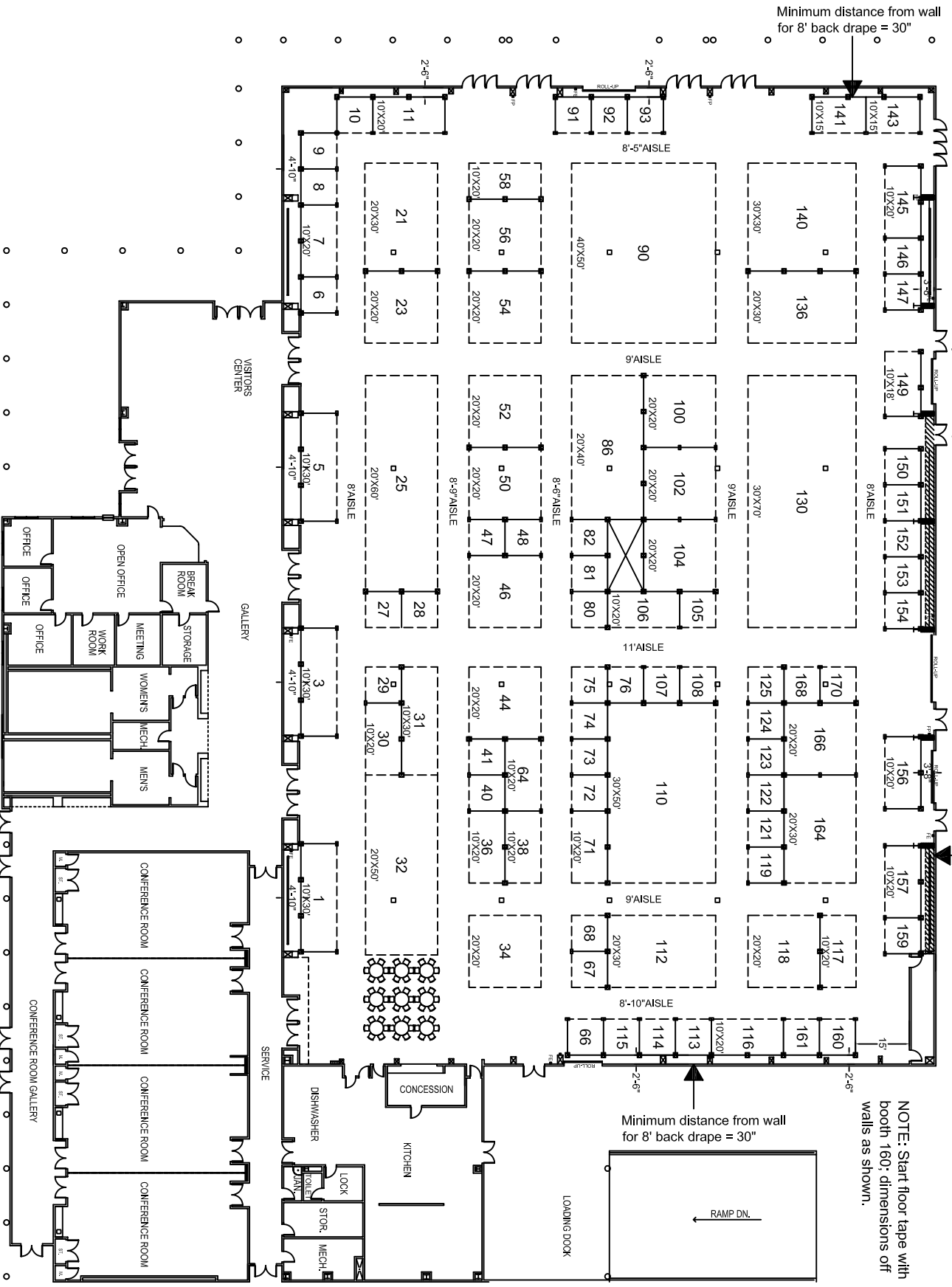

WILLAMETTE VALLEY AG EXPO 2011

NOVEMBER 15-17, 2011
LINN COUNTY FAIR & EXPO CENTER - Willamette Events Center
ALBANY, OR

ALL OTHER BOOTH SIZES, AS INDICATED
49' - 10' X 10' BOOTHS
8' MINIMUM AISLES

Trade Show & Exposition Services

 P.O. Box 10859 - Portland, OR 97296
 PH 503.228.6800 - FAX 503.228.6808